



INSPECTION DEPARTMENT
DROPPED OBJECT CANOPY INSPECTION
DATE: 07.11.11

DROPPED

OBJECT

CANOPY

INSPECTION REPORT



INSPECTION DEPARTMENT
DROPPED OBJECT CANOPY INSPECTION
DATE: 07.11.11

DROPPED OBJECT CANOPY (OUTER CANOPY CABLES & DAMPERS)				
DAMPNER PRESSURES TO BE SET AT 15-20 BAR, RAMS EXTENDED 20-30mm WIRE ROPES IN GOOD CONDITION, ANCHORAGES SECURE				
NO. 1 NEAREST TOWER	PRESSURE	EXTENSION	DEFECT	COMMENTS
DAMPNER/CABLE NO.1 SOUTH	40 Bar	28 mm	None	
DAMPNER/CABLE NO.2 SOUTH	40 Bar	42 mm	None	
DAMPNER/CABLE NO.3 SOUTH	40 Bar	42 mm	None	
DAMPNER/CABLE NO.4 SOUTH	40 Bar	43 mm	None	
DAMPNER/CABLE NO.5 SOUTH	40 Bar	46 mm	None	
DAMPNER/CABLE NO.6 SOUTH	45 Bar	42 mm	None	
DAMPNER/CABLE NO.7 SOUTH	38 Bar	28 mm	None	
DAMPNER/CABLE NO.8 SOUTH	38 Bar	28 mm	None	
DAMPNER/CABLE NO.9 SOUTH	38 Bar	27 mm	None	
DAMPNER/CABLE NO.10 SOUTH	30 Bar	105 mm	None	
DAMPNER /CABLE NO.11 SOUTH	40 Bar	43 mm	None	
DAMPNER/CABLE NO. 12 SOUTH	35 Bar	46 mm	None	
DAMPNER/CABLE NO. 13 SOUTH	40 Bar	43 mm	None	
DAMPNER/CABLE NO. 14 SOUTH	35 Bar	28 mm	None	
DAMPNER/CABLE NO. 15 SOUTH	30 Bar	110 mm	None	
DAMPNER/CABLE NO. 16 SOUTH	40 Bar	142 mm	None	
DAMPNER/CABLE NO.17 SOUTH	40 Bar	95 mm	None	
DAMPNER/CABLE NO. 18 SOUTH	40 Bar	68 mm	None	
DAMPNER/CABLE NO. 1 NORTH	42 Bar	53 mm	None	
DAMPNER/CABLE NO. 2 NORTH	38 Bar	42 mm	None	
DAMPNER/CABLE NO. 3 NORTH	40 Bar	28 mm	None	
DAMPNER/CABLE NO. 4 NORTH	40 Bar	33 mm	None	
DAMPNER/CABLE NO. 5 NORTH	44 Bar	43 mm	None	
DAMPNER/CABLE NO. 6 NORTH	32 Bar	58 mm	None	
DAMPNER/CABLE NO. 7 NORTH	36 Bar	71 mm	None	
DAMPNER/CABLE NO. 8 NORTH	40 Bar	42 mm	None	
DAMPNER/CABLE NO. 9 NORTH	40 Bar	40 mm	None	
DAMPNER/CABLE NO. 10 NORTH	20 Bar	60 mm	None	
DAMPNER/CABLE NO. 11 NORTH	35 Bar	51 mm	None	
DAMPNER/CABLE NO. 12 NORTH	40 Bar	28 mm	None	
DAMPNER/CABLE NO.13 NORTH	35 Bar	29 mm	None	
DAMPNER/CABLE NO. 14 NORTH	32 Bar	54 mm	None	
DAMPNER/CABLE NO. 15 NORTH	40 Bar	28 mm	None	
DAMPNER/CABLE NO. 16 NORTH	40 Bar	42 mm	None	
DAMPNER/CABLE NO. 17 NORTH	40 Bar	28 mm	None	
DAMPNER/CABLE NO. 18 NORTH	40 Bar	28 mm	None	



INSPECTION DEPARTMENT
DROPPED OBJECT CANOPY INSPECTION
DATE: 07.11.11

DROPPED OBJECT CANOPY INSPECTION (DECK AREA)		
N.E. DECK AREA	DEFECT	COMMENTS
PANEL M	None	Satisfactory Water staining evident on underside of
PANEL L	None	" boards throughout
PANEL J	None	" "
PANEL H1	None	"
PANEL H	None	" "
PANEL G	None	"
PANEL F	None	" "
PANEL D	None	"
PANEL C	None	" "
PANEL C2	None	"
PANEL E	None	" "
PANEL B	None	"
PANEL A N	None	" "
PANEL A S	None	"
HANDRAILS/KICKPLATES	None	Satisfactory Paint breakdown evident – wear and tear evident
NONSLIP COATING	None	Satisfactory
FILLET STRIPS	None	Satisfactory
S.E. DECK AREA	DEFECT	COMMENTS
PANEL M	None	Satisfactory Water staining evident on underside of
PANEL K	None	" boards throughout
PANEL J	None	" "
PANEL H1	None	"
PANEL H	None	" "
PANEL G	None	"
PANEL F1	None	" "
PANEL E	None	"
PANEL D	None	" "
PANEL C	None	"
PANEL C2	None	" "
PANEL B	None	"
PANEL A N	None	" "
PANEL A S	None	"
HANDRAILS/KICKPLATES	None	Satisfactory Paint breakdown evident – wear and tear evident
NONSLIP COATING	None	
FILLET STRIPS	None	



INSPECTION DEPARTMENT
DROPPED OBJECT CANOPY INSPECTION
DATE: 07.11.11

DROPPED OBJECT CANOPY INSPECTION (DECK AREA)		
N.W. DECK AREA	DEFECT	COMMENTS
PANEL Q1	None	Satisfactory Water staining evident on underside of
PANEL P1	None	boards throughout
PANEL N	None	"
PANEL H1	None	"
PANEL H	None	"
PANEL G	None	"
PANEL F1	None	"
PANEL D	None	"
PANEL C	None	"
PANEL C2	None	"
PANEL E	None	"
PANEL B	None	"
PANEL A N	None	"
PANEL A S	None	"
HANDRAILS/KICKPLATES	None	Satisfactory Paint breakdown evident – wear and tear evident
NONSLIP COATING	None	Satisfactory
FILLET STRIPS	None	Satisfactory
S.W. DECK AREA	DEFECT	COMMENTS
PANEL Q	None	Satisfactory Water staining evident on underside of
PANEL P	None	boards throughout
PANEL N	None	"
PANEL H1	None	"
PANEL H	None	"
PANEL G	None	"
PANEL F	None	"
PANEL E	None	"
PANEL D	None	"
PANEL C	None	"
PANEL C2	None	"
PANEL B	None	"
PANEL A N	None	"
PANEL A S	None	"
HANDRAILS/KICKPLATES	None	Satisfactory Paint breakdown evident – wear and tear evident
NONSLIP COATING	None	Satisfactory
FILLET STRIPS	None	Satisfactory



INSPECTION DEPARTMENT
DROPPED OBJECT CANOPY INSPECTION
DATE: 07.11.11

DROPPED OBJECT CANOPY INSPECTION (NETTING)		
NORTH & SOUTH NETTING	DEFECT	COMMENTS
SOUTH WEST NET FREE FROM DAMAGE/OBJECTS	None	Clear
SOUTH EAST NET U-BOLTS PRESENT AND SECURE	None	
NORTH EAST NET FREE FROM DAMAGE/OBJECTS	None	Clear
NORTH WEST NET FREE FROM DAMAGE/OBJECTS	None	Clear
ANY OTHER OBSERVATIONS		
STAIRCASE AND ENCLOSURE	DEFECT	COMMENTS
ENCLOSURE STRUCTURE	None	
ENCLOSURE STRUCTURE FIXINGS TO DECK	None	
STAIRTOWER AND PARAPETS	None	
DOOR HINGES, LATCH AND LOCK	None	
STAIRCASE HOLDING DOWN BOLTS	None	
1ST FLIGHT TREADS AND BOLTS	None	
1ST FLIGHT HANDRAILS AND FIXINGS	None	
LOADING PLATFORM HANDRAILS, FLOOR, FIXINGS	None	
2ND FLIGHT TREADS AND BOLTS	None	
2ND FLIGHT HANDRAILS AND FIXINGS	None	
2ND LANDING HANDRAIL, FLOOR AND FIXINGS	None	
3RD FLIGHT TREADS AND BOLTS	None	
3RD FLIGHT HANDRAILS AND FIXINGS	Yes	Handrail connection to stringer
3RD LANDING HANDRAIL, FLOOR AND FIXINGS	None	East Side Bolt loose
4TH FLIGHT TREADS AND BOLTS	None	
4TH FLIGHT HANDRAILS AND FIXINGS	None	
STAIRTOWER STEELWORK AND FIXINGS	None	
TOP 3 TREADS AND FIXINGS	None	
UPPER HANDRAILS AND FIXINGS	None	
OTHER COMMENTS	None	
EMERGENCY LADDER	DEFECT	COMMENTS
UPPER LADDER SECTION	None	Satisfactory
UPPER LADDER TOWER FIXINGS	None	"
LOWER LADDER SECTION	None	"
LOWER LADDER TOWER FIXINGS	Yes	Loose bolt on x-over section
TOWER FIXINGS TO DECK	None	Satisfactory
ENCLOSURE STRUCTURE	None	"
ENCLOSURE FIXINGS TO DECK AND PARAPETS	None	"
ENCLOSURE DOOR HINGES AND LOCKS	None	"



INSPECTION DEPARTMENT
DROPPED OBJECT CANOPY INSPECTION
DATE: 07.11.11

DROPPED OBJECT CANOPY INSPECTION (MAIN STRUCTURE BREAKDOWN)			
NORTH EAST SECTION		DEFECTS	COMMENTS
BEAM 1	CROSS RAFTER EAST	None	Satisfactory
BEAM 2	CROSS RAFTER EAST	None	"
BEAM 3	CROSS RAFTER EAST	None	"
BEAM 4	SPLAY RAFTER	None	"
BEAM 5	UPPER HITCHING RAIL	None	"
BEAM 6	SPLAY RAFTER	None	"
BEAM 7	UPPER HITCHING RAIL	None	"
BEAM 8	SPLAY RAFTER	None	"
BEAM 9	UPPER HITCHING BRACE	None	"
BEAM 10	RAFTER SPLAY BRACE	None	"
BEAM 11	RAFTER SPLAY BRACE	None	"
BEAM 12	RAFTER SPLAY BRACE	None	"
BEAM 13	HORIZONTAL BRACE	None	"
BEAM 14	RAFTER SPLAY BRACE	None	"
BEAM 15	RAFTER SPLAY BRACE	None	"
BEAM 16	RAFTER SPLAY BRACE	None	"
BEAM 17	HORIZONTAL BRACE	None	"
BEAM 18	UPPER HITCHING BRACE	None	"
BEAM 19	VERTICAL END STAY	None	"
BEAM 20	VERTICAL STAY	None	Satisfactory
BEAM 21	VERTICAL STAY	None	"
BEAM 22	VERTICAL STAY	None	"
BEAM 23	VERTICAL END STAY	None	"
BEAM 24	LOWER VERTICAL STAY	None	"
BEAM 25	LOWER VERTICAL STAY	None	"
BEAM 26	LOWER HITCHING END	None	"
BEAM 27	LOWER HITCHING RAIL	None	"
BEAM 28	LOWER HITCHING RAIL	None	"
BEAM 29	LOWER HITCHING END	None	"
BEAM 30	MACALLOY BRACING	None	"
BEAM 31	MACALLOY BRACING	None	"
BEAM 32	COLUMN	None	"
BEAM 33	COLUMN	None	"
BEAM 34	COLUMN	None	"
BEAM 35	ANCHORAGE BEAM	None	"
BEAM 36	STUB COLUMN	None	"
BEAM 37	STUB COLUMN	None	"
BEAM 38	STUB COLUMN	None	"
CHORD 1	CHORD CLAMPS	None	"
CHORD 2	CHORD CLAMPS	None	"
CHORD 3	CHORD CLAMPS	None	"



INSPECTION DEPARTMENT
DROPPED OBJECT CANOPY INSPECTION
DATE: 07.11.11

DROPPED OBJECT CANOPY INSPECTION (MAIN STRUCTURE BREAKDOWN)			
NORTH WEST SECTION		DEFECTS	COMMENTS
BEAM 1	CROSS RAFTER WEST	None	Satisfactory
BEAM 2	CROSS RAFTER WEST	None	"
BEAM 3	CROSS RAFTER WEST	None	"
BEAM 4	SPLAY RAFTER	None	"
BEAM 5	UPPER HITCHING RAIL	None	"
BEAM 6	SPLAY RAFTER	None	"
BEAM 7	UPPER HITCHING RAIL	None	"
BEAM 8	SPLAY RAFTER	None	"
BEAM 9	UPPER HITCHING BRACE	None	"
BEAM 10	RAFTER SPLAY BRACE	None	"
BEAM 11	RAFTER SPLAY BRACE	None	"
BEAM 12	RAFTER SPLAY BRACE	None	"
BEAM 13	HORIZONTAL BRACE	None	"
BEAM 14	RAFTER SPLAY BRACE	None	"
BEAM 15	RAFTER SPLAY BRACE	None	"
BEAM 16	RAFTER SPLAY BRACE	None	"
BEAM 17	HORIZONTAL BRACE	None	"
BEAM 18	UPPER HITCHING BRACE	None	"
BEAM 19	VERTICAL END STAY	None	"
BEAM 20	VERTICAL STAY	None	"
BEAM 21	VERTICAL STAY	None	Satisfactory
BEAM 22	VERTICAL STAY	None	"
BEAM 23	VERTICAL END STAY	None	"
BEAM 24	LOWER VERTICAL STAY	None	"
BEAM 25	LOWER VERTICAL STAY	None	"
BEAM 26	LOWER HITCHING END	None	"
BEAM 27	LOWER HITCHING RAIL	None	"
BEAM 28	LOWER HITCHING RAIL	None	"
BEAM 29	LOWER HITCHING END	None	"
BEAM 30	MACALLOY BRACING	None	"
BEAM 31	MACALLOY BRACING	None	"
BEAM 32	COLUMN	None	"
BEAM 33	COLUMN	None	"
BEAM 34	COLUMN	None	"
BEAM 35	ANCHORAGE BEAM	None	"
BEAM 36	STUB COLUMN	None	"
BEAM 37	STUB COLUMN	None	"
BEAM 38	STUB COLUMN	None	"
CHORD 1	CHORD CLAMPS	None	"
CHORD 2	CHORD CLAMPS	None	"
CHORD 3	CHORD CLAMPS	None	"



INSPECTION DEPARTMENT
DROPPED OBJECT CANOPY INSPECTION
DATE: 07.11.11

DROPPED OBJECT CANOPY INSPECTION (MAIN STRUCTURE BREAKDOWN)			
SOUTH EAST SECTION		DEFECT	COMMENTS
BEAM 1	CROSS RAFTER EAST	None	Satisfactory
BEAM 2	CROSS RAFTER EAST	None	"
BEAM 3	CROSS RAFTER EAST	None	"
BEAM 4	SPLAY RAFTER	None	"
BEAM 5	UPPER HITCHING RAIL	None	"
BEAM 6	SPLAY RAFTER	None	"
BEAM 7	UPPER HITCHING RAIL	None	"
BEAM 8	SPLAY RAFTER	None	"
BEAM 9	UPPER HITCHING BRACE	None	"
BEAM 10	RAFTER SPLAY BRACE	None	"
BEAM 11	RAFTER SPLAY BRACE	None	"
BEAM 12	RAFTER SPLAY BRACE	None	"
BEAM 13	HORIZONTAL BRACE	None	"
BEAM 14	RAFTER SPLAY BRACE	None	"
BEAM 15	RAFTER SPLAY BRACE	None	"
BEAM 16	RAFTER SPLAY BRACE	None	"
BEAM 17	HORIZONTAL BRACE	None	"
BEAM 18	UPPER HITCHING BRACE	None	"
BEAM 19	VERTICAL END STAY	None	"
BEAM 20	VERTICAL STAY	None	"
BEAM 21	VERTICAL STAY	None	Satisfactory
BEAM 22	VERTICAL STAY	None	"
BEAM 23	VERTICAL END STAY	None	"
BEAM 24	LOWER VERTICAL STAY	None	"
BEAM 25	LOWER VERTICAL STAY	None	"
BEAM 26	LOWER HITCHING END	None	"
BEAM 27	LOWER HITCHING RAIL	None	"
BEAM 28	LOWER HITCHING RAIL	None	"
BEAM 29	LOWER HITCHING END	None	"
BEAM 30	MACALLOY BRACING	None	"
BEAM 31	MACALLOY BRACING	None	"
BEAM 32	COLUMN	None	"
BEAM 33	COLUMN	None	"
BEAM 34	COLUMN	None	"
BEAM 35	ANCHORAGE BEAM	None	"
BEAM 36	STUB COLUMN	None	"
BEAM 37	STUB COLUMN	None	"
BEAM 38	STUB COLUMN	None	"
CHORD 1	CHORD CLAMPS	None	"
CHORD 2	CHORD CLAMPS	None	"
CHORD 3	CHORD CLAMPS	None	"



INSPECTION DEPARTMENT
DROPPED OBJECT CANOPY INSPECTION
DATE: 07.11.11

DROPPED OBJECT CANOPY INSPECTION (MAIN STRUCTURE BREAKDOWN)			
SOUTH WEST SECTION		DEFECTS	COMMENTS
BEAM 1	CROSS RAFTER WEST	None	Satisfactory
BEAM 2	CROSS RAFTER WEST	None	"
BEAM 3	CROSS RAFTER WEST	None	"
BEAM 4	SPLAY RAFTER	None	"
BEAM 5	UPPER HITCHING RAIL	None	"
BEAM 6	SPLAY RAFTER	None	"
BEAM 7	UPPER HITCHING RAIL	None	"
BEAM 8	SPLAY RAFTER	None	"
BEAM 9	UPPER HITCHING BRACE	None	"
BEAM 10	RAFTER SPLAY BRACE	None	"
BEAM 11	RAFTER SPLAY BRACE	None	"
BEAM 12	RAFTER SPLAY BRACE	None	"
BEAM 13	HORIZONTAL BRACE	None	"
BEAM 14	RAFTER SPLAY BRACE	None	"
BEAM 15	RAFTER SPLAY BRACE	None	"
BEAM 16	RAFTER SPLAY BRACE	None	"
BEAM 17	HORIZONTAL BRACE	None	"
BEAM 18	UPPER HITCHING BRACE	None	"
BEAM 19	VERTICAL END STAY	None	"
BEAM 20	VERTICAL STAY	None	"
BEAM 21	VERTICAL STAY	None	"
BEAM 22	VERTICAL STAY	None	Satisfactory
BEAM 23	VERTICAL END STAY	None	"
BEAM 24	LOWER VERTICAL STAY	None	
BEAM 25	LOWER VERTICAL STAY	None	
BEAM 26	LOWER HITCHING END	None	
BEAM 27	LOWER HITCHING RAIL	None	
BEAM 28	LOWER HITCHING RAIL	None	
BEAM 29	LOWER HITCHING END	None	
BEAM 30	MACALLOY BRACING	None	
BEAM 31	MACALLOY BRACING	None	
BEAM 32	COLUMN	None	
BEAM 33	COLUMN	None	
BEAM 34	COLUMN	None	
BEAM 35	ANCHORAGE BEAM	None	
BEAM 36	STUB COLUMN	None	
BEAM 37	STUB COLUMN	None	
BEAM 38	STUB COLUMN	None	
CHORD 1	CHORD CLAMPS	None	
CHORD 2	CHORD CLAMPS	None	
CHORD 3	CHORD CLAMPS	None	



INSPECTION DEPARTMENT
DROPPED OBJECT CANOPY INSPECTION
DATE: 07.11.11

DROPPED OBJECT CANOPY INSPECTION (PRIMARY STEELWORK)		
SOUTH EAST SECTION	DEFECT	COMMENTS
BEAM 1	None	Satisfactory
BEAM 2	None	"
BEAM 3	None	"
BEAM 4	None	"
BEAM 5	None	"
BEAM 6	None	"
BEAM 7	None	"
BEAM 8	None	"
BEAM 9	None	"
BEAM 10	None	"
SOUTH WEST SECTION	DEFECT	COMMENT
BEAM 1	None	Satisfactory
BEAM 2	None	"
BEAM 3	None	"
BEAM 4	None	"
BEAM 5	None	"
BEAM 6	None	"
BEAM 7	None	"
BEAM 8	None	"
BEAM 9	None	"
BEAM 10	None	"
NORTH EAST SECTION	DEFECT	COMMENT
BEAM 1	None	Satisfactory
BEAM 2	None	"
BEAM 3	None	"
BEAM 4	None	"
BEAM 5	None	"
BEAM 6	None	"
BEAM 7	None	"
BEAM 8	None	"
BEAM 9	None	"
BEAM 10	None	"
NORTH WEST SECTION	DEFECT	COMMENT
BEAM 1	None	Satisfactory
BEAM 2	None	"
BEAM 3	None	"
BEAM 4	None	"
BEAM 5	None	"
BEAM 6	None	"
BEAM 7	None	"
BEAM 8	None	"
BEAM 9	None	"
BEAM 10	None	"



INSPECTION DEPARTMENT
DROPPED OBJECT CANOPY INSPECTION
DATE: 07.11.11

DROPPED OBJECT CANOPY INSPECTION (SECONDARY STEEL DIAG/VERT BRACINGS)		
BEAM NUMBER ONE AT WEST SIDE THROUGH TO BEAM NUMBER SEVENTEEN ON EAST SIDE		
NORTH SIDE		
	DEFECTS	COMMENTS
BEAM 1	None	Satisfactory
BEAM 2	None	"
BEAM 3	None	"
BEAM 4	None	"
BEAM 5	None	"
BEAM 6	None	"
BEAM 7	None	"
BEAM 8	None	"
BEAM 9	None	"
BEAM 10	None	"
BEAM 11	None	"
BEAM 12	None	"
BEAM 13	None	"
BEAM 14	None	"
BEAM 15	None	"
BEAM 16	None	"
BEAM 17	None	"
DROPPED OBJECT CANOPY INSPECTION (SECONDARY STEEL DIAG/VERT BRACINGS)		
BEAM NUMBER ONE AT WEST SIDE THROUGH TO BEAM NUMBER SEVENTEEN ON EAST SIDE		
SOUTH SIDE		
	DEFECT	COMMENTS
BEAM 1	None	Satisfactory
BEAM 2	None	"
BEAM 3	None	"
BEAM 4	None	"
BEAM 5	None	"
BEAM 6	None	"
BEAM 7	None	"
BEAM 8	None	"
BEAM 9	None	"
BEAM 10	None	"
BEAM 11	None	"
BEAM 12	None	"
BEAM 13	None	"
BEAM 14	None	"
BEAM 15	None	"
BEAM 16	None	"
BEAM 17	None	"



INSPECTION DEPARTMENT
DROPPED OBJECT CANOPY INSPECTION
DATE: 07.11.11

DROPPED OBJECT CANOPY INSPECTION(CENTRE STEELWORK SECTION)		
NORTH EAST SECTION		
	DEFECT	COMMENTS
BEAM BR1	None	
BEAM BR2 W	None	
BEAM BR2 E	None	
BEAM BR3	None	
BEAM BR4	None	
BEAM BR5	None in part	South connection not visible from footpath
BEAM BR6	None in part	South connection not visible from footpath
BEAM BR8 NE	None	
BEAM BR8 NW	None	
BEAM BR8 SW	None	
BEAM BR8 SE	None	
BEAM BR9 N	None	
BEAM BR9 S		Beam connections not visible from footpath
BEAM BR10 N	None	
BEAM BR10 S	None	Beam connections not visible from footpath
BEAM BR11 N	None	
BEAM BR11 S	None	
BEAM BR12 N	None	
BEAM BR12 S	None	
BEAM BR13 NW	None	
BEAM BR13 SW	None	
BEAM BR13 NE	None	
BEAM BR13 SE	None	
BEAM BR14 N	None	
BEAM BR14 S	None	
BEAM SB1	None	
BEAM SB2	None	
BEAM SB3	None	
BEAM SB4	None	
BEAM SB5	None	
BEAM SB6	None	
BEAM SB7	None	
BEAM SB8	None	
BEAM SB9	None	
BEAM SB12	None	
BEAM SB13	None in part	Eastside connection not visible from f/path
BEAM SB14		Beam connections not visible from footpath
BEAM SB15	None in part	South beam connection not visible from f/path
BEAM SB16	None	
BEAM SB17	None in part	West beam connection not visible from f/path



INSPECTION DEPARTMENT
DROPPED OBJECT CANOPY INSPECTION
DATE: 07.11.11

DROPPED OBJECT CANOPY INSPECTION(CENTRE STEELWORK SECTION)

NORTH WEST SECTION	DEFECT	COMMENTS
BEAM BR1	None in part	South connection not visible from footpath
BEAM BR2 W	None in part	South connection not visible from footpath
BEAM BR2 E	None in part	South connection not visible from footpath
BEAM BR3	None in part	South connection not visible from footpath
BEAM BR4	None in part	South connection not visible from footpath
BEAM BR5	None	
BEAM BR7	None	
BEAM BR8 NE	None	
BEAM BR8 NW	None	
BEAM BR8 SW	None	
BEAM BR8 SE	None	
BEAM BR10 N	None	
BEAM BR10 S		Beam connections not visible from footpath
BEAM BR11 N	None	
BEAM BR11 S		Beam connections not visible from footpath
BEAM BR12 N	None	
BEAM BR12 S		Beam connections not visible from footpath
BEAM BR13 NW	None	
BEAM BR13 SW		Beam connections not visible from footpath
BEAM BR13 NE	None	
BEAM BR13 SE		Beam connections not visible from footpath
BEAM BR14 N	None	
BEAM BR14 S	None in part	East beam connection not visible from footpath
BEAM BR15 N	None	
BEAM BR15 S		Beam connections not visible from footpath
BEAM SB1	None	
BEAM SB2A	None	
BEAM SB3A	None	
BEAM SB4A	None	
BEAM SB5A	None	
BEAM SB6A	None	
BEAM SB7A	None	
BEAM SB10	None	
BEAM SB11	None	
BEAM SB12	None	
BEAM SB13		Beam connections not visible from footpath
BEAM SB14		Beam connections not visible from footpath
BEAM SB15 A		Beam connections not visible from footpath
BEAM SB16	None in part	West connection not visible from footpath
BEAM SB17		Beam connections not visible from footpath



INSPECTION DEPARTMENT
DROPPED OBJECT CANOPY INSPECTION
DATE: 07.11.11

DROPPED OBJECT CANOPY INSPECTION(CENTRE STEELWORK SECTION)		
SOUTH EAST SECTION	DEFECT	COMMENTS
BEAM BR1	None	
BEAM BR2 W	None	
BEAM BR2 E	None	
BEAM BR3	None	
BEAM BR4	None	
BEAM BR5	None	
BEAM BR6	None	
BEAM BR8 NE	None	
BEAM BR8 NW	None	
BEAM BR8 SW	None	
BEAM BR8 SE	None	
BEAM BR9 N		Beam connection not visible from footpath
BEAM BR9 S	None	
BEAM BR10 N		Beam connection not visible from footpath
BEAM BR10 S	None	
BEAM BR11 N	None in part	West connection not visible from footpath
BEAM BR11 S	None	
BEAM BR12 N	None	
BEAM BR12 S	None	
BEAM BR13 NW	None	
BEAM BR13 SW	None	
BEAM BR13 NE	None	
BEAM BR13 SE	None in part	East connection not visible from footpath
BEAM BR14 N	None	
BEAM BR14 S	None	
BEAM SB1	None	
BEAM SB2	None	
BEAM SB3	None	
BEAM SB4	None	
BEAM SB5	None	
BEAM SB6	None	
BEAM SB7	None	
BEAM SB8	None	
BEAM SB9	None	
BEAM SB12A	None	
BEAM SB13	None	
BEAM SB14A	None	
BEAM SB15A	None in part	North connection not visible from footpath
BEAM SB16	None	
BEAM SB17	None in part	West connection not visible from footpath



INSPECTION DEPARTMENT
DROPPED OBJECT CANOPY INSPECTION
DATE: 07.11.11

DROPPED OBJECT CANOPY INSPECTION(CENTRE STEELWORK SECTION)		
SOUTH WEST SECTION	DEFECT	COMMENTS
BEAM BR1		Beam connection not visible from footpath
BEAM BR2 W		Beam connection not visible from footpath
BEAM BR2 E		Beam connection not visible from footpath
BEAM BR3		Beam connection not visible from footpath
BEAM BR4		Beam connection not visible from footpath
BEAM BR5	None	
BEAM BR7	None	
BEAM BR8 NE	None	
BEAM BR8 NW	None	
BEAM BR8 SW	None	
BEAM BR8 SE	None	
BEAM BR10 N		Beam connection not visible from footpath
BEAM BR10 S	None	
BEAM BR11 N		Beam connection not visible from footpath
BEAM BR11 S	None	
BEAM BR12 N		Beam connection not visible from footpath
BEAM BR12 S	None	
BEAM BR13 NW		West connection not visible from footpath
BEAM BR13 SW	None	
BEAM BR13 NE		West connection not visible from footpath
BEAM BR13 SE	None	
BEAM BR14 N	None	
BEAM BR14 S	None	
BEAM BR15 N		Beam connection not visible from footpath
BEAM BR15 S	None	
BEAM SB1	None	
BEAM SB2A	None	
BEAM SB3A	None	
BEAM SB4A	None	
BEAM SB5A	None	
BEAM SB6A	None	
BEAM SB7A	None	
BEAM SB10	None	
BEAM SB11	None	
BEAM SB12A	None	
BEAM SB13		Beam connection not visible from footpath
BEAM SB14A		Beam connection not visible from footpath
BEAM SB15		Beam connection not visible from footpath
BEAM SB16	None in part	West connection not visible from f/path
BEAM SB17		Beam connection not visible from footpath



INSPECTION DEPARTMENT
DROPPED OBJECT CANOPY INSPECTION
DATE: 07.11.11

DROPPED OBJECT CANOPY (TURNBUCKLE AND CABLES)		
VISUAL INSPECTION FROM FOOTPATH OF SPLIT PINS, SHACKLES, BOLTS, TURNBUCKLES		
NO. 1 NEAREST TOWER	DEFECTS	COMMENTS
TURNBUCKLE/CABLE NO.1 SOUTH	None	
TURNBUCKLE/CABLE NO.2 SOUTH	None	
TURNBUCKLE/CABLE NO.3 SOUTH	None	
TURNBUCKLE/CABLE NO.4 SOUTH	None	
TURNBUCKLE/CABLE NO.5 SOUTH	None	
TURNBUCKLE/CABLE NO.6 SOUTH	None	
TURNBUCKLE/CABLE NO.7 SOUTH	None	
TURNBUCKLE/CABLE NO.8 SOUTH	None	
TURNBUCKLE/CABLE NO.9 SOUTH	None	
TURNBUCKLE/CABLE NO.10 SOUTH	None	
TURNBUCKLE/CABLE NO.11 SOUTH	None	
TURNBUCKLE/CABLE NO. 12 SOUTH	None	
TURNBUCKLE/CABLE NO. 13 SOUTH	None	
TURNBUCKLE/CABLE NO. 14 SOUTH	None	
TURNBUCKLE/CABLE NO. 15 SOUTH	None	
TURNBUCKLE/CABLE NO. 16 SOUTH	None	
TURNBUCKLE/CABLE NO.17 SOUTH	None	
TURNBUCKLE/CABLE NO. 18 SOUTH	None	
TURNBUCKLE/CABLE NO. 1 NORTH	None	
TURNBUCKLE/CABLE NO. 2 NORTH	None	
TURNBUCKLE/CABLE NO. 3 NORTH	None	
TURNBUCKLE/CABLE NO. 4 NORTH	None	
TURNBUCKLE/CABLE NO. 5 NORTH	None	
TURNBUCKLE/CABLE NO. 6 NORTH	None	
TURNBUCKLE/CABLE NO. 7 NORTH	None	
TURNBUCKLE/CABLE NO. 8 NORTH	None	
TURNBUCKLE/CABLE NO. 9 NORTH	None	
TURNBUCKLE/CABLE NO. 10 NORTH	None	
TURNBUCKLE/CABLE NO. 11 NORTH	None	
TURNBUCKLE/CABLE NO. 12 NORTH	None	
TURNBUCKLE/CABLE NO.13 NORTH	None	
TURNBUCKLE/CABLE NO. 14 NORTH	None	
TURNBUCKLE/CABLE NO. 15 NORTH	None	
TURNBUCKLE/CABLE NO. 16 NORTH	None	
TURNBUCKLE/CABLE NO. 17 NORTH	None	
TURNBUCKLE/CABLE NO. 18 NORTH	None	



INSPECTION DEPARTMENT
DROPPED OBJECT CANOPY INSPECTION
DATE: 07.11.11

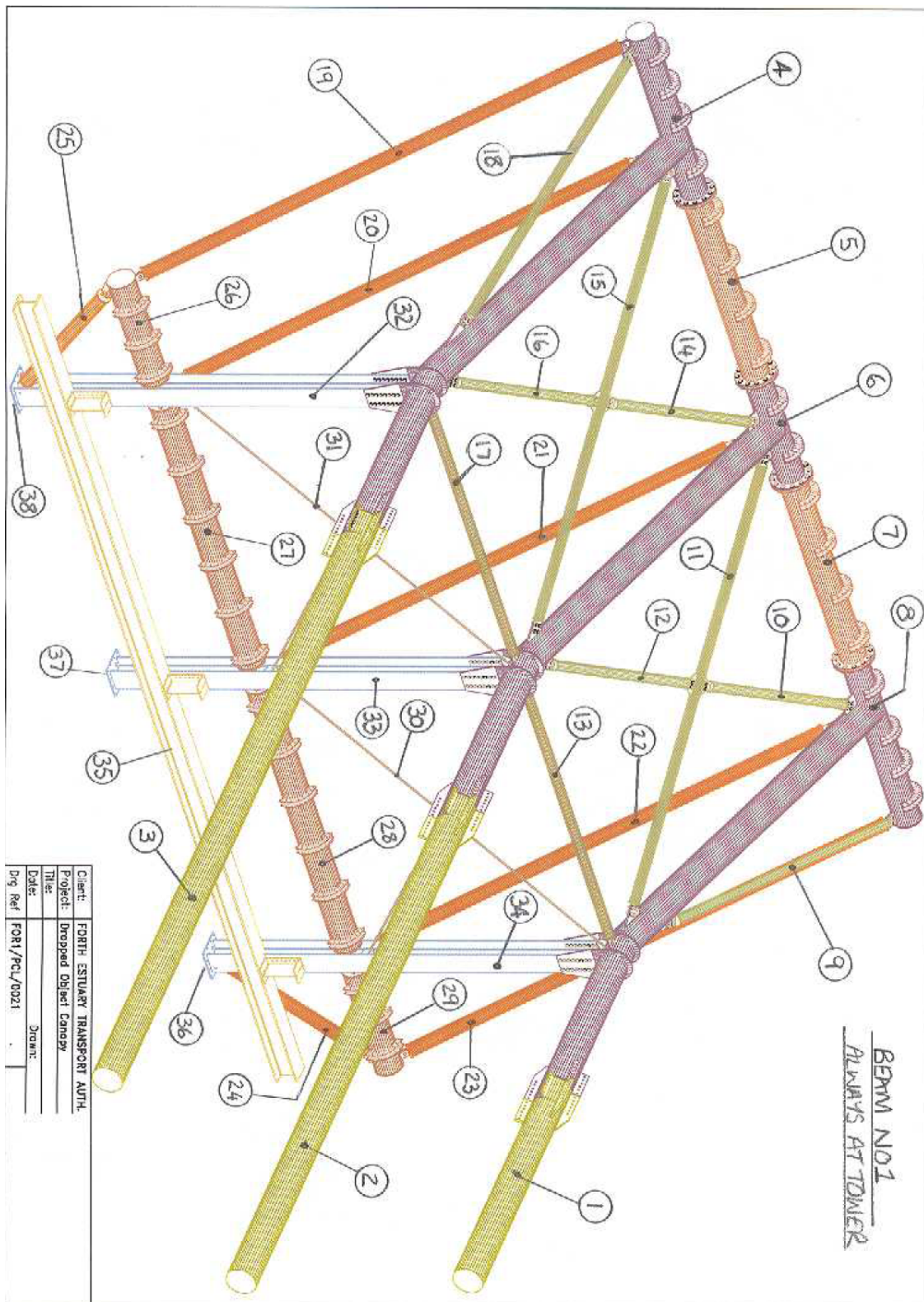



INSPECTION DEPARTMENT
DROPPED OBJECT CANOPY INSPECTION
DATE: 07.11.11

PRIMARY STEELWORK
DOC INSPECTION

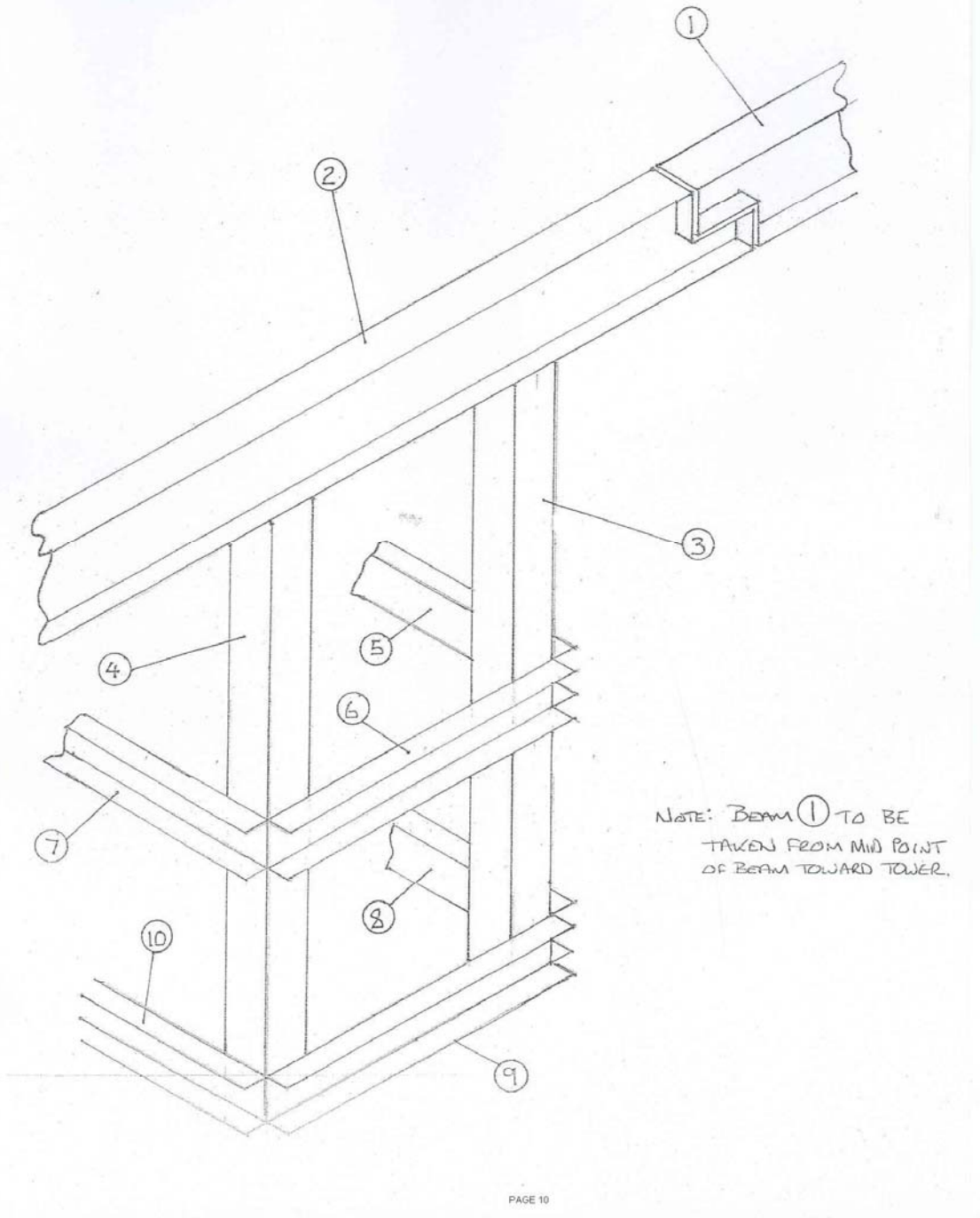



INSPECTION DEPARTMENT
DROPPED OBJECT CANOPY INSPECTION
DATE: 07.11.11

AS BUILT

↑ NORTH

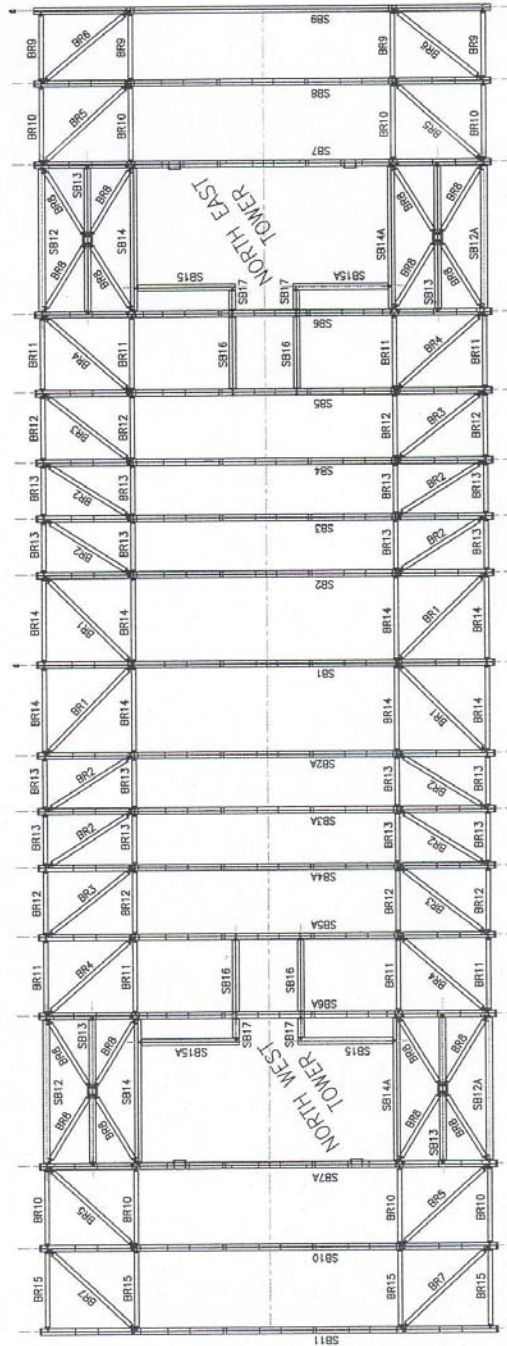

PAGE 12

Client:	FORTH ESTUARY TRANSPORT AUTH.
Project:	Dropped Object Canopy
Title:	Platform Deck Components
Date:	06/01/2006
Drawn:	D.L.A.
Drawn:	FOR/PCL/041
Drawn:	FOR

PIERSE

Heavy Contracting Limited
Lightbridge Yard, Chatterbox,
NORTHWICH, Cheshire, CH9 5JL



INSPECTION DEPARTMENT
DROPPED OBJECT CANOPY INSPECTION
DATE: 07.11.11

AS BUILT

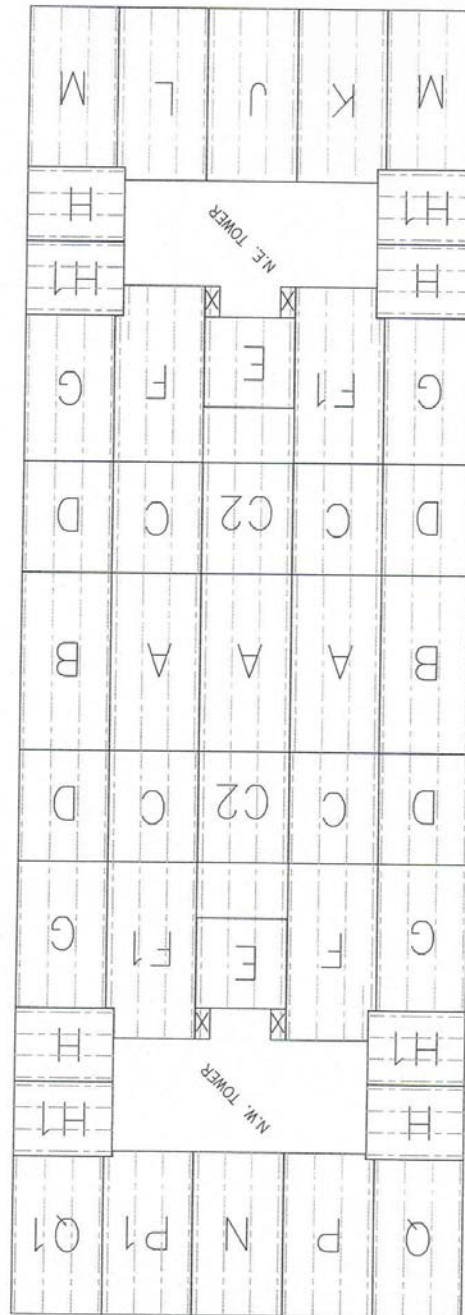

DECK PANELS: GENERAL ARRANGEMENT

Client:	FORTH ESTUARY TRANSPORT AUTH.
Project:	Dropped Object Canopy
Title:	G.A. DECK PANELS
Date:	06/01/2006
Drawn:	B.L.A.
Rev:	
Doc Ref:	FOR1/PCL/100

PIERSE

Pierse Contracting Limited
Unit 10, Chatterbox,
Highway 100, Chatterbox,
Ontario, Canada